

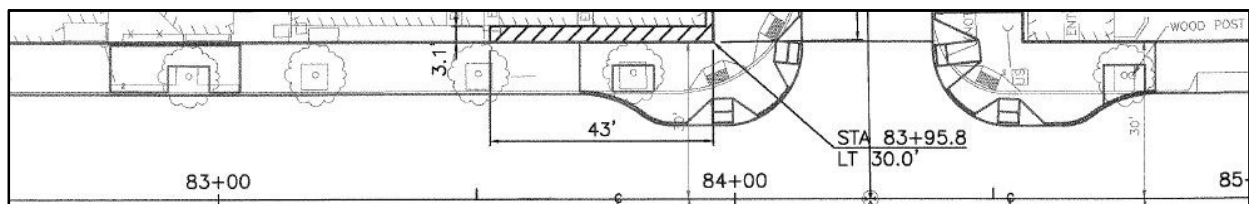

# Seattle Department of Transportation

## The Americans with Disabilities Act (ADA) Transition Plan for the Seattle Public Right-of-Way

### Appendix 5.3b: Accessible Pedestrian Signal Checklist





## Accessible Pedestrian Signal Checklist

**Inspector:** \_\_\_\_\_

**Date:** \_\_\_\_\_

**Intersection Location:** \_\_\_\_\_

**Intersection Leg:** \_\_\_\_\_

Is APS provided at this leg (or portion thereof) of the intersection?      Yes      No  
 (If Yes, complete this form)

	Clear Space & Operable Part Attributes	Assessment		
		Front	N/A	Side
1	Is a 30"x48" (2.5'x4') min. clear ground space provided adjacent to APS pushbutton for either a front or a side approach?	Front	N/A	Side
2	If pushbutton is obstructed, please identify the obstruction.			
2a	If an obstruction is present, is the pushbutton accessible using a side reach of no more than 10" over the obstruction?	Yes	N/A	No
3	Does the clear ground space at the pushbutton connect to the Pedestrian Access Route (PAR) with clear access to the crosswalk?	Yes	N/A	No
3a	If No, please identify the route obstruction.			
4	Max. running slope of clear space (48" dim.)?		%	
4a	Is the running slope at or below the slope of the roadway or PAR?	Yes		No
5	Max. cross slope of clear space (30" dim.)?		%	
5a	Is the cross slope limited to 2% maximum?	Yes		No
6	Is the centerline of the pushbutton located between 15" and 48" above the ground?	Yes		No
6a	Height of pushbutton?		"	
7	Pushbutton operable by one hand with force ≤ 5 lbs.?	Yes		No
	<b>General APS and Detector Attributes</b>			
8	Is an integral sign provided to identify the purpose of the pushbutton?	Yes		No
9	Does the pushbutton clearly indicate which crosswalk is actuated?	Yes		No
10	Does the pushbutton incorporate a locator tone?	Yes		No



## Accessible Pedestrian Signal Checklist

11	Is a pilot light used to indicate pushbutton actuation?	Yes		No
11a	Does the pilot light remain illuminated upon actuation until the walk interval begins?	Yes	N/A	No
12b	If a pilot light is used, is the speech message "wait" announced upon each actuation?	Yes	N/A	No
13	Is a vibrotactile walk indication provided by a tactile arrow on the pushbutton that vibrates during the walk interval?	Yes		No
13a	Is the tactile arrow on the pushbutton aligned parallel to the crosswalk?	Yes	N/A	No
13b	Does the tactile arrow contrast with its background (dark on light or light on dark)?	Yes	N/A	No
14	Is an audible walk indication provided during the walk interval?	Yes		No
14a	If Yes, is the audible indication a percussive tone or a speech message?	Tone	Other or N/A	Speech
14b	Is the audible walk indication audible from the beginning of the associated crosswalk?	Yes	N/A	No
14c	If a speech walk message is used, is it patterned after the model: "Broadway. Walk sign is on to cross Broadway" or "Walk sign is on for all crossings" for exclusive ped phasing model?	Yes	N/A	No
<b>Location Attributes</b>				
15	Is the pushbutton located no more than 10' from the edge of curb, shoulder, or pavement?	Yes		No
15a	If Yes, what is distance?	"		
16	Is there another APS pushbutton at the corner?	Yes		No
16a	If Yes, is the distance to the next pushbutton at least 10'? <i>(If Yes, walk indication shall be percussive tone; if No, a speech walk message is required)</i>	Yes	N/A	No
16b	If < 10' between two APS devices at a corner, list any potential reason why it may not be feasible.			
<b>Other Considerations</b>				
17	Please indicate any limitation when the APS is not available/operational (time of day or day of week).			