

## Project Area Map

- 1 24TH AVE E AND E LOUISA ST**  
2 striped curb bulbs and High Friction Surface Treatments.
- 2 24TH AVE E AND E LYNN ST**  
New walk and bike signal, curb ramps, crossing improvements, and High Friction Surface Treatments.
- 3 23RD AVE E AND E WARD ST**  
2 striped curb bulbs and High Friction Surface Treatments.
- 4 23RD AVE E AND E JOHN ST**  
New protected eastbound left-turn signal phase, curb ramps, and crossing improvements.

## Project Timeline

<b>Spring 2019</b>	<ul style="list-style-type: none"> <li>• Share conceptual design for Segment 2 improvements</li> <li>• Gather community feedback on planned safety improvements</li> </ul>
<b>Summer 2019</b>	<ul style="list-style-type: none"> <li>• Installation of skid-resistant surface treatments</li> </ul>
<b>Winter 2019</b>	<ul style="list-style-type: none"> <li>• Complete design for Segment 2 improvements</li> </ul>
<b>2020</b>	<ul style="list-style-type: none"> <li>• Construction of Segment 2 improvements</li> </ul>

This project is funded by the 9-year Levy to Move Seattle, approved by voters in 2015. Learn more about the levy at [www.seattle.gov/LevytoMoveSeattle](http://www.seattle.gov/LevytoMoveSeattle).

# 23RD AVE VISION ZERO PROJECT

## Segment 2 - Crossing and Transit Stop Improvements

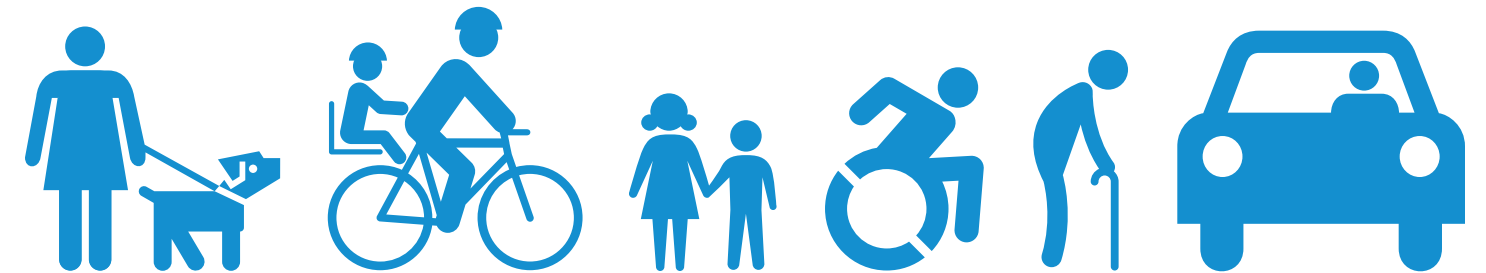

### BACKGROUND

Since 2014, there have been 130 crashes and 63 injuries to people walking, biking, and driving on 23rd Ave E/24th Ave E between E John St and E Roanoke St.

We're enhancing safety and mobility on 23rd Ave E/24th Ave E between E John St and E Roanoke St as part of our Vision Zero efforts to reach zero traffic deaths and serious injuries by 2030.

### PROJECT OVERVIEW

Last fall we completed Segment 1 of the project. We changed 23rd Ave E/24th Ave E between E John St and Boyer Ave E from 2 northbound lanes to 1 northbound lane and 1 center turn lane.

Next, we'll complete installation of High Friction Surface Treatments (HFST) as soon as this summer. We'll add HFST at intersections where collision rates are high when road conditions are wet and slippery:

- 24th Ave E/E Louisa St
- 24th Ave E/E Lynn St
- 24th Ave E/E Helen St/Turner Way

We are finalizing the design for Segment 2. Current planned improvements include:

- New walk and bike signal and associated curb ramp improvements at E Lynn St
- Protected eastbound left-turn signal phase at 23rd Ave E/E John St
- 2 striped curb bulbs at 24th Ave E/E Louisa St and 23rd Ave E/E Ward St

### VISION ZERO

Vision Zero is the City of Seattle's effort to end traffic deaths and serious injuries on city streets by 2030. Learn more about our engineering, education, and enforcement efforts by visiting: [www.seattle.gov/visionzero](http://www.seattle.gov/visionzero).

### CONTACT

[23rdAveCorridor3@seattle.gov](mailto:23rdAveCorridor3@seattle.gov)  
(206) 900-8717  
[www.seattle.gov/visionzero/projects/23rd-ave-e](http://www.seattle.gov/visionzero/projects/23rd-ave-e)

# PLANNED INTERSECTION IMPROVEMENTS

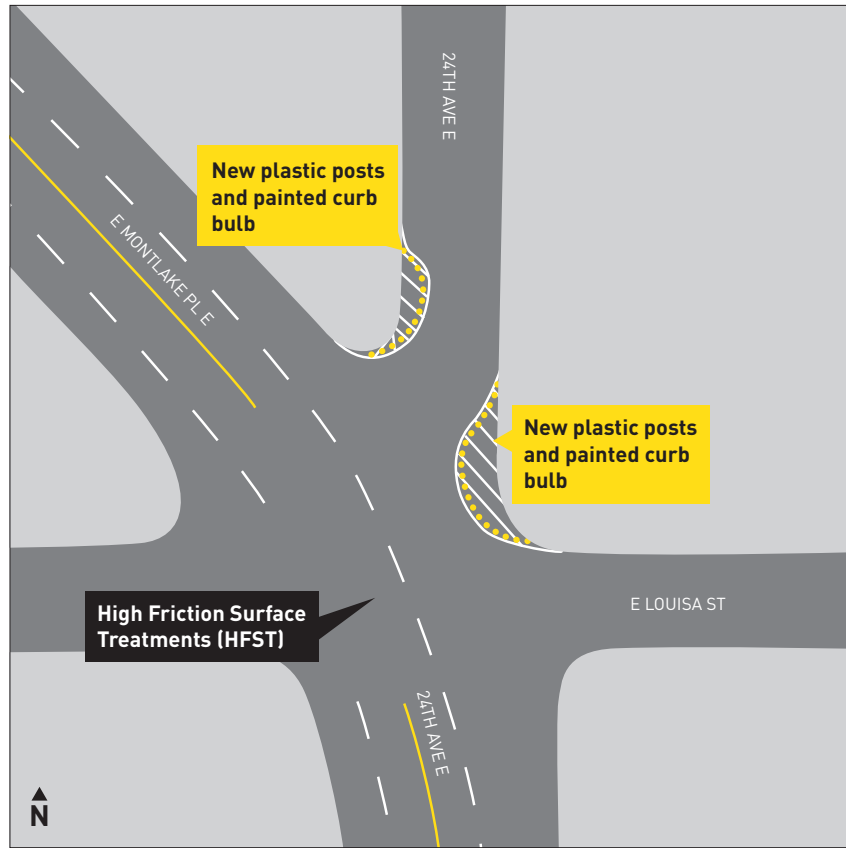

## 24TH AVE E AND E LOUISA ST

### Painted Curb Bulbs

Curb bulbs reduce the number and severity of traffic collisions by increasing the visibility of vulnerable users - people walking and biking - and decreasing the distance they have to travel to get across the street.

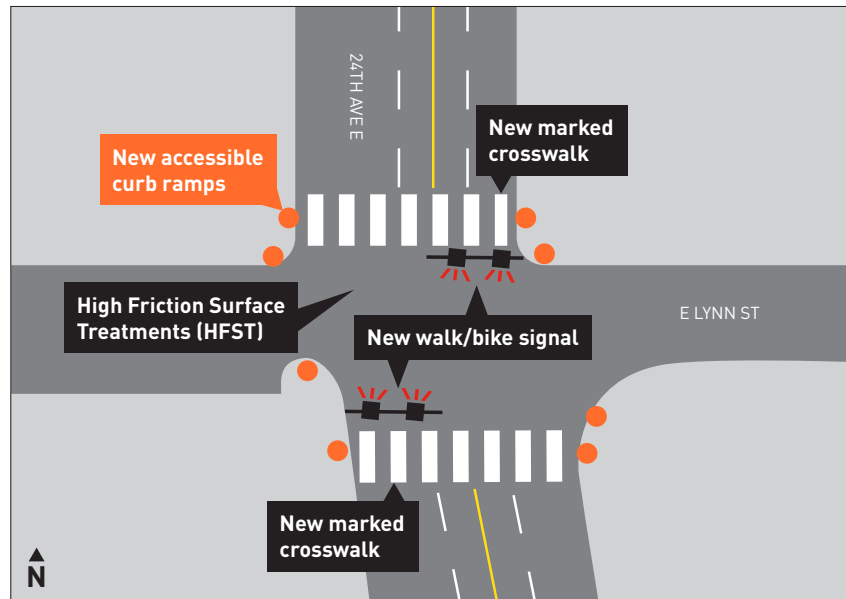

## 24TH AVE E AND E LYNN ST

### Signalized Crosswalk

Walk/bike signals stop car traffic to allow people who walk and bike to safely cross the intersection.

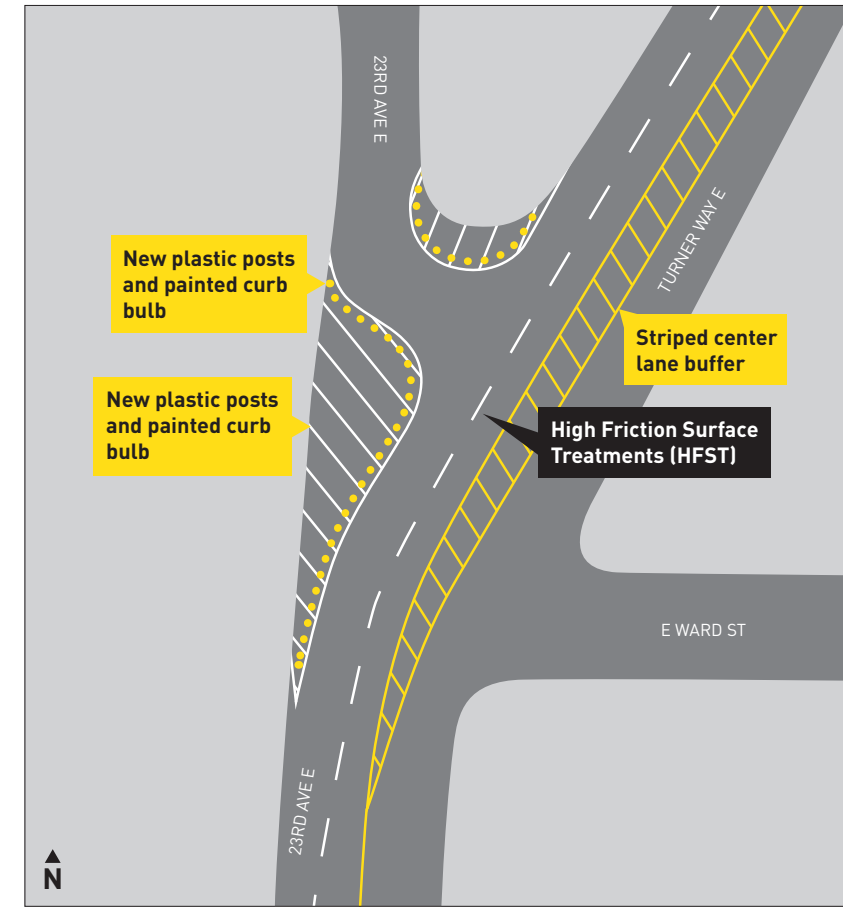

## 23RD AVE E AND E WARD ST

### High Friction Surface Treatments (HFST)

HFST adds a thin layer of coarse material on top of the street to improve skid-resistance to the pavement. We're adding HFST at intersections where collision rates are high when road conditions are wet and slippery.

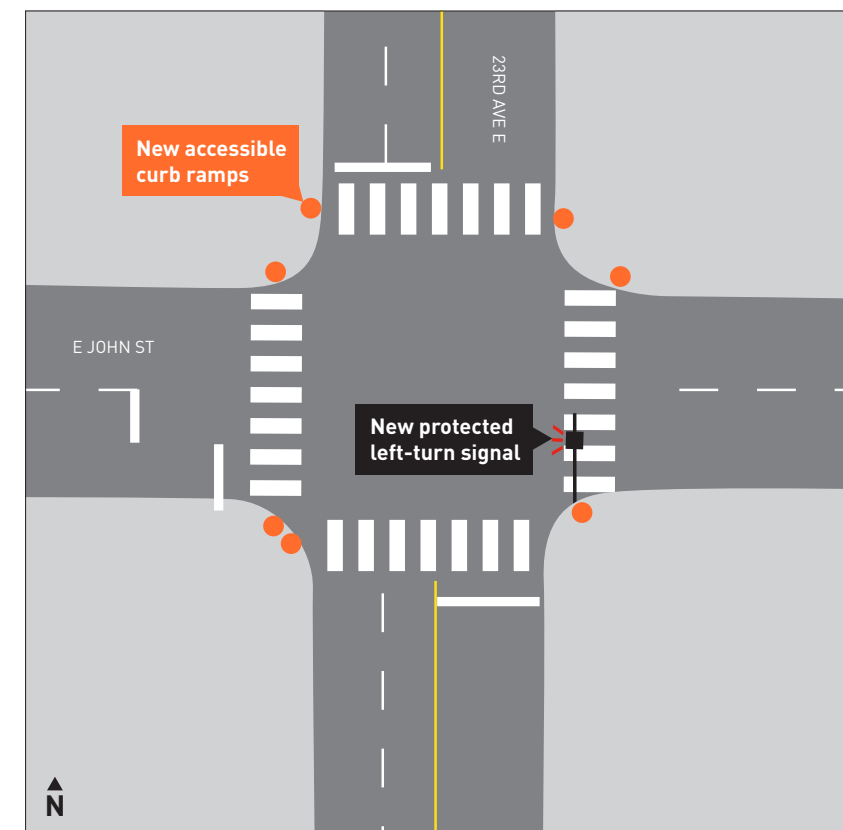

## 23RD AVE E AND E JOHN ST

### Protected Left Turn Signal

A protected eastbound left-turn signal phase will reduce opportunities for collisions.